



FULL

BOILER OPERATION (AM)
Day: Tuesday
Time: 9:00 am - 2:00 pm
Course Sessions: 15
Start Date: 01/14 • End Date: 04/21

FULL

BOILER OPERATION (PM)
Day: Tuesday
Time: 5:00 pm - 10:00 pm
Course Sessions: 15
Start Date: 01/14 • End Date: 04/21

FULL

BOILER OPERATION (PM)
Day: Wednesday
Time: 4:00 pm - 9:00 pm
Course Sessions: 15
Start Date: 01/15 • End Date: 04/22

FULL

COMMERCIAL HEATING & COOLING I (AM)
Day: Thursday
Time: 8:30 am - 1:30 pm
Course Sessions: 15
Start Date: 01/16 • End Date: 04/23

FULL

COMMERCIAL HEATING & COOLING I (AM)
Day: Wednesday
Time: 8:00 am - 1:00 pm
Course Sessions: 15
Start Date: 01/15 • End Date: 04/22

FULL

COMMERCIAL HEATING & COOLING I (PM)
Day: Monday
Time: 4:00 pm - 9:00 pm
Course Sessions: 15
Start Date: 01/13 • End Date: 04/27

FULL

COMMERCIAL HEATING & COOLING II (PM)
Day: Thursday
Time: 5:00 pm - 10:00 pm
Course Sessions: 15
Start Date: 01/16 • End Date: 04/23

FULL

CRITICAL SYSTEMS (PM)
Day: Monday
Time: 5:00 pm - 8:00 pm
Course Sessions: 10
Start Date: 01/13 • End Date: 03/23

CRITICAL SYSTEMS OPERATIONS & MAINTENANCE (AM)
Day: Friday
Time: 9:00 am - 1:00 pm
Course Sessions: 15
Start Date: 01/17 • End Date: 05/01

CHIEF ENGINEER (AM)
Day: Wednesday
Time: 9:00 am - 12:00 pm
Course Sessions: 10
Start Date: 01/15 • End Date: 03/18

FULL

CHIEF ENGINEER (PM)
Day: Monday
Time: 4:00 pm - 9:00 pm
Course Sessions: 10
Start Date: 01/13 • End Date: 03/23

FULL

ELECTRICITY FOR ENGINEERS I (PM)
Day: Thursday
Time: 4:00 pm - 9:00 pm
Course Sessions: 15
Start Date: 01/16 • End Date: 04/23

FULL

ELECTRICITY FOR ENGINEERS I (PM)
Day: Monday
Time: 5:00 pm - 10:00 pm
Course Sessions: 15
Start Date: 01/13 • End Date: 04/27

FULL

ELECTRICITY FOR ENGINEERS I (PM)
Day: Wednesday
Time: 4:00 pm - 9:00 pm
Course Sessions: 15
Start Date: 01/15 • End Date: 04/22

FULL

ELECTRICITY FOR ENGINEERS I (AM)
Day: Friday
Time: 9:00 am - 2:00 pm
Course Sessions: 15
Start Date: 01/17 • End Date: 05/01

FULL

ELECTRICITY FOR ENGINEERS II (AM)
Day: Monday
Time: 9:00 am - 2:00 pm
Course Sessions: 15
Start Date: 01/13 • End Date: 04/27

FULL

ELECTRICITY FOR ENGINEERS II (AM)
Day: Tuesday
Time: 8:30 am - 1:30 pm
Course Sessions: 15
Start Date: 01/14 • End Date: 04/28

FULL

ELECTRICITY FOR ENGINEERS II (AM)
Day: Saturday
Time: 8:00 am - 1:00 pm
Course Sessions: 15
Start Date: 01/11 • End Date: 04/25

FULL

ENERGY CONSERVATION (AM)
Day: Saturday
Time: 9:00 am - 2:00 pm
Course Sessions: 15
Start Date: 01/11 • End Date: 04/25

FACILITIES SUSTAINABILITY (PM)
Day: Thursday
Time: 4:00 pm - 9:00 pm
Course Sessions: 15
Start Date: 01/16 • End Date: 04/23

HEALTHCARE MAINTENANCE SYSTEMS (AM)
Day: Tuesday
Time: 8:00 am - 12:00 pm
Course Sessions: 15
Start Date: 01/14 • End Date: 04/21

HEALTHCARE LOGISTICS AND COMPLIANCE (PM)
Day: Thursday
Time: 5:00 pm - 9:30 pm
Course Sessions: 10
Start Date: 01/16 • End Date: 03/19

HOSPITALITY EQUIPMENT MAINTENANCE & REPAIR (PM)
Day: Tuesday
Time: 4:00 pm - 8:30 pm
Course Sessions: 15
Start Date: 01/14 • End Date: 04/21

HOTEL MAINTENANCE SYSTEMS (PM)
Day: Wednesday
Time: 5:00 pm - 9:30 pm
Course Sessions: 15
Start Date: 01/15 • End Date: 04/22

INDOOR AIR QUALITY (AM)
Day: Thursday
Time: 8:00 am - 1:00 pm
Course Sessions: 15
Start Date: 01/16 • End Date: 04/23

INDOOR AIR QUALITY (PM)
Day: Thursday
Time: 4:00 pm - 9:00 pm
Course Sessions: 15
Start Date: 01/16 • End Date: 04/23

PLUMBING REPAIR & MAINTENANCE (PM)
Day: Monday
Time: 5:00 pm - 9:30 pm
Course Sessions: 10
Start Date: 01/13 • End Date: 03/23

PLUMBING REPAIR & MAINTENANCE (PM)
Day: Wednesday
Time: 5:00 pm - 9:30 pm
Course Sessions: 10
Start Date: 01/15 • End Date: 03/18

PNEUMATIC CONTROLS & DDC (PM)
Day: Wednesday
Time: 5:00 pm - 10:00 pm
Course Sessions: 15
Start Date: 01/15 • End Date: 04/22

ROOFTOP EQUIPMENT/OPERATION & MAINTENANCE (AM)
Day: Wednesday
Time: 9:00 am - 12:00 pm
Course Sessions: 15
Start Date: 01/15 • End Date: 04/22

FULL

TESTING AND BALANCING (PM)
Day: Thursday
Time: 5:00 pm - 10:00 pm
Course Sessions: 15
Start Date: 01/16 • End Date: 04/23

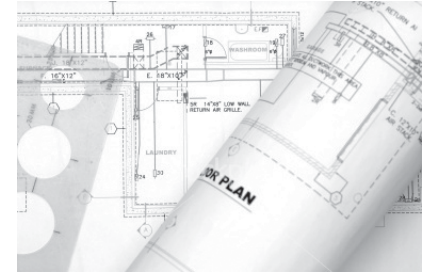

FULL

UNDERSTANDING PLAN DRAWINGS (AM)
Day: Tuesday
Time: 8:30 am - 11:30 am
Course Sessions: 10
Start Date: 01/14 • End Date: 03/17

FULL

UNDERSTANDING PLAN DRAWINGS (PM)
Day: Saturday
Time: 12:00 pm - 3:00 pm
Course Sessions: 10
Start Date: 01/11 • End Date: 03/14



BLENDING ONLINE / CLASSROOM COURSES:

Please note that all classroom sessions for blended courses are mandatory attendance. Students will be informed of online class dates by instructor.

FULL

ENERGY CONSERVATION (PM) **
Day: Tuesday
Time: 5:00 pm - 10:00 pm
Course Sessions: 12
Start Date: 01/14 • End Date: 03/31

FULL

INDOOR AIR QUALITY (PM) **
Day: Wednesday
Time: 5:00 pm - 10:00 pm
Course Sessions: 12
Start Date: 01/15 • End Date: 04/01

GENERAL EDUCATION



MATH 122 (PM)

Day: Friday
Time: 5:00 pm - 7:45 pm
Course Sessions: 17
Start Date: 01/24 • End Date: 05/15

PRINCIPLES OF EFFECTIVE SPEAKING ** (PM) (BLENDED/ONLINE)

Day: Thursday
Time: 5:00 pm - 9:00 pm
Course Sessions: 5
01/23, 02/13, 03/12, 04/16, 04/30

RHETORIC 101 (PM)

Day: Monday
Time: 7:00 pm - 9:45 pm
Course Sessions: 17
Start Date: 01/27 • End Date: 05/18

CERTIFICATE CLASSES



FIRE ALARM SYSTEMS (PM)

Day: Wednesday
Time: 5:00 pm - 9:30 pm
Course Sessions: 10
Start Date: 01/15 • End Date: 03/18

INDUSTRIAL MAINTENANCE (PM)

Day: Tuesday
Time: 4:00 pm - 8:30 pm
Course Sessions: 12
Start Date: 01/14 • End Date: 03/31

INDUSTRIAL MAINTENANCE (PM)

Day: Thursday
Time: 4:00 pm - 8:30 pm
Course Sessions: 12
Start Date: 01/16 • End Date: 04/02

LABOR HISTORY (AM)

Day: Monday
Time: 8:00 am - 11:00 am
Course Sessions: 7
Start Date: 01/13 • End Date: 03/02

LABOR HISTORY (PM)

Day: Monday
Time: 4:00 pm - 7:00 pm
Course Sessions: 7
Start Date: 01/13 • End Date: 03/02

LABOR HISTORY (AM)

Day: Monday
Time: 8:00 am - 11:00 am
Course Sessions: 7
Start Date: 03/09 • End Date: 04/20



LOCKSMITH (PM)

Day: Thursday
Time: 5:00 pm - 8:00 pm
Course Sessions: 5
Start Date: 01/09 • End Date: 02/13

LOCKSMITH (PM)

Day: Thursday
Time: 5:00 pm - 8:00 pm
Course Sessions: 5
Start Date: 02/20 • End Date: 03/26

LOCKSMITH (AM)

Day: Saturday
Time: 8:00 am - 11:00 am
Course Sessions: 5
Start Date: 01/04 • End Date: 02/15

LOCKSMITH (AM)

Day: Saturday
Time: 8:00 am - 11:00 am
Course Sessions: 5
Start Date: 02/22 • End Date: 04/25

VARIABLE FREQUENCY DRIVE (PM)**

Day: Friday
Time: 4:00 pm - 7:00 pm
Course Sessions: 5
Start Date: 01/17 • End Date: 02/14

VARIABLE FREQUENCY DRIVE (PM)**

Day: Friday
Time: 4:00 pm - 7:00 pm
Course Sessions: 5
Start Date: 02/21 • End Date: 03/20

EDUCATION IS THE KEY TO SUCCESS!



Education Department Contacts:
(312) 372-9870 Ext. 4000

Jamie Howard Ext. 4125
Veronica Tinley Ext. 4121
Nancy Carey Ext. 4123

** All classroom sessions are *mandatory* attendance

Local 399 believes that education is the key to success! Our 2020 Spring schedule is designed to provide students with a diverse curriculum that will challenge the new journeyman/apprentice as well as advance the careers of our Engineers and Chiefs.

Please check the Local 399 website www.iuoe399.org for updates on classes, available seminars, certificate availability as well as cancellation or late start alters due to inclement weather.

STUDENTS PLEASE NOTE:

No Classes will be held on the following dates:

January 20th
April 10th • April 11th